

# CLUTCH RELEASE CYLINDER

## CLUTCH RELEASE CYLINDER REMOVAL/INSTALLATION

### CAUTION:

- Fluid will damage painted surfaces. Be careful not to spill any on painted surfaces. If fluid does get on painted surfaces, wipe it off immediately.
1. Remove in the order indicated in the table.
  2. Install in the reverse order of removal.
  3. Bleed the air from the system.
  4. Inspect and adjust the clutch pedal.

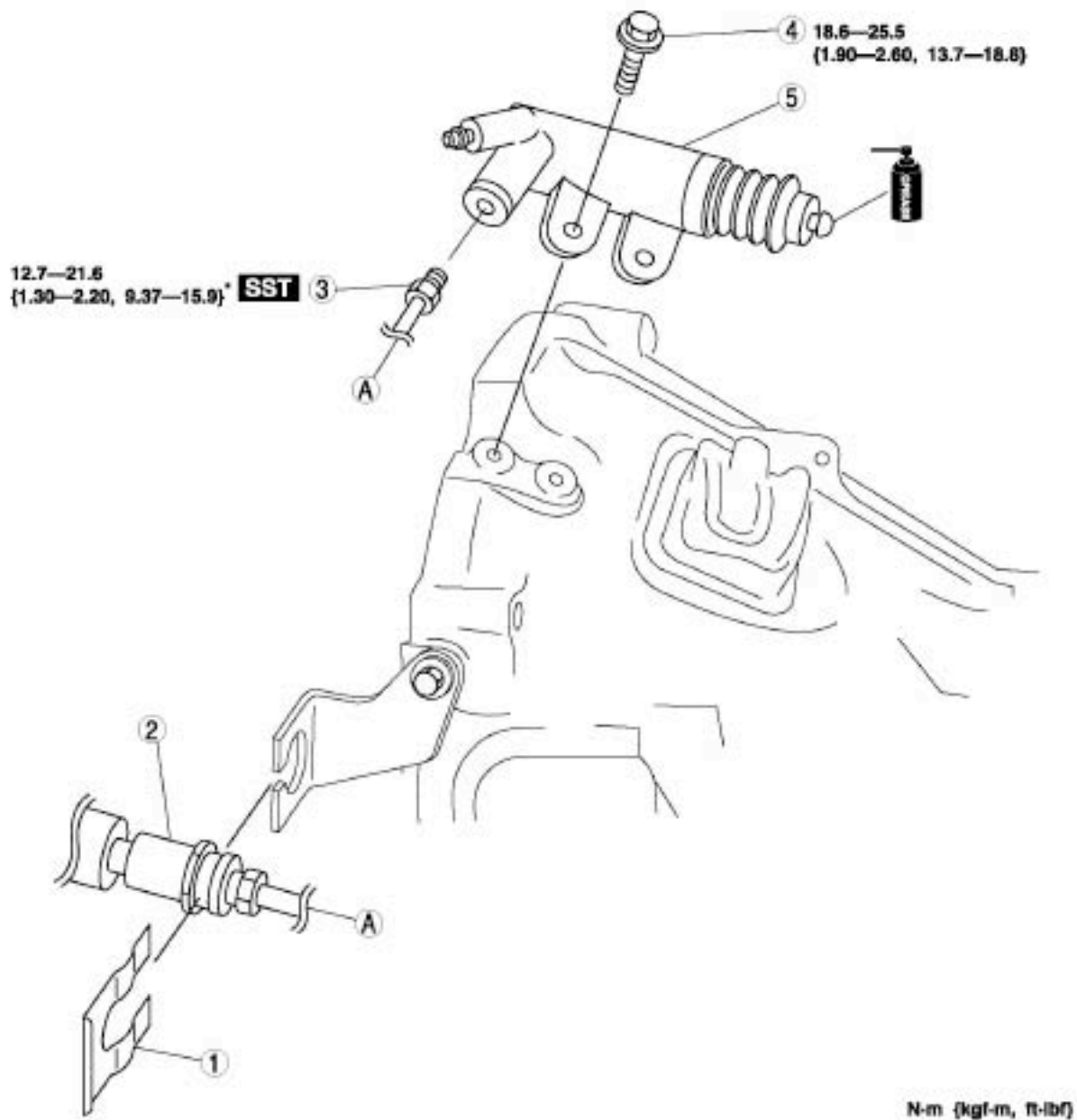

\*49 0259 770B

1	Clip
2	Clutch pipe, clutch hose

3	Clutch pipe
4	Bolt
5	Clutch release cylinder

## CLUTCH RELEASE CYLINDER DISASSEMBLY/ASSEMBLY

1. Disassemble in the order indicated in the table.
2. Assemble in the reverse order of disassembly.

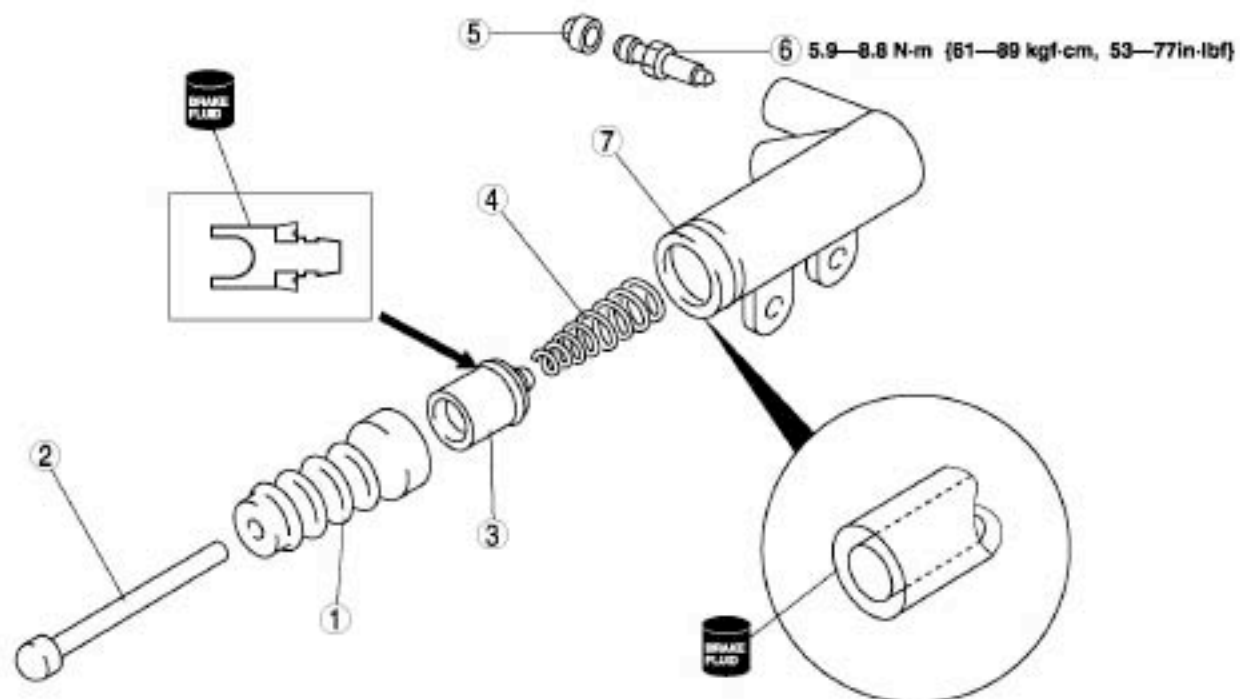

1	Boot
2	Push rod
3	Piston, piston cup component
4	Return spring
5	Bleeder cap
6	Bleeder screw
7	Clutch release cylinder body