

© 2010 Mazda Motor of America, Inc.

<b>Subject:</b> HESITATION / IDLE VIBRATION DUE TO CRACKED ENGINE MOUNT	<b>Bulletin No:</b> 01-016/10
	<b>Last Issued:</b> 06/16/2010

## BULLETIN NOTE

- This bulletin supersedes the previous bulletin 01-021/06 issued 6/13/06, 01-001/09 issued 01/20/09, and 01-016/10 issued 02/17/10. The APPLICABLE MODEL(S)/VINS, PART(S) INFORMATION, and WARRANTY INFORMATION have been revised.
- Changes are noted below beside the change bar in Red.

## APPLICABLE MODEL(S)/VINS

- 2004-2010 RX-8 (M/T) vehicles with VINs lower than JM1FE\*\*\*\*\*404840 (produced before April 13, 2010)
- 2004-2010 RX-8 (A/T) vehicle with VINs lower than JM1 FE\*\*\*\* \*\* 404240 (produced before December 2, 2009)

## DESCRIPTION

Some vehicles may experience the following symptoms.

- On manual transmission vehicles, when decelerating in 3rd gear with engine speed less than 3,000 RPM at approximately 30 MPH (50km/h), then quickly depressing the accelerator pedal again, a hesitation may occur. This symptom can only be observed in this engine speed and vehicle speed range.
- On automatic transmission vehicles, when at a stop in D range, excessive engine/body vibration may occur. This body vibration does not occur in P or N range.

Depending on the driving condition or engine condition, the RH side engine mount rubber may deform. As a result, the RH side engine mount can crack. As a mass production change, the material of the engine mount rubber has been changed.

Customers having this concern should have their vehicle repaired using the following procedure.

## REPAIR PROCEDURE

1. Verify customer concern.
2. Place vehicle on hoist.
3. Remove engine cover. Refer to MS3 online service information or Workshop Manual section 01-10 ENGINE COVER REMOVAL/INSTALLATION procedure.
4. Raise and support vehicle on hoist.
5. Remove front wheels.  
**Tightening Torque: 147 N.m (108 ft-lb)**
6. Support engine using an engine hoist.

**CONSUMER NOTICE:** The information and instructions in this bulletin are intended for use by skilled technicians. Mazda technicians utilize the proper tools/equipment and take training to correctly and safely maintain Mazda vehicles. These instructions should not be performed by "do-it-yourselfers." Customers should not assume this bulletin applies to their vehicle or that their vehicle will develop the described concern. To determine if the information applies, customers should contact their nearest authorized Mazda dealership. Mazda North American Operations reserves the right to alter the specifications and contents of this bulletin without obligation or advance notice. All rights reserved. No part of this bulletin may be reproduced in any form or by any means, electronic or mechanical---including photocopying and recording and the use of any kind of information storage and retrieval system ---without permission in writing.

7. On RH side of engine, remove bolts/nuts in the following order:
  - a. Engine mount bracket-to-engine mount (1).  
Tightening Torque: 37-52 N.m (28-38 ft-lb)
  - b. Engine mount-to-front sub frame (2).  
Tightening Torque: 45-63 N.m (33-46 ft-lb)

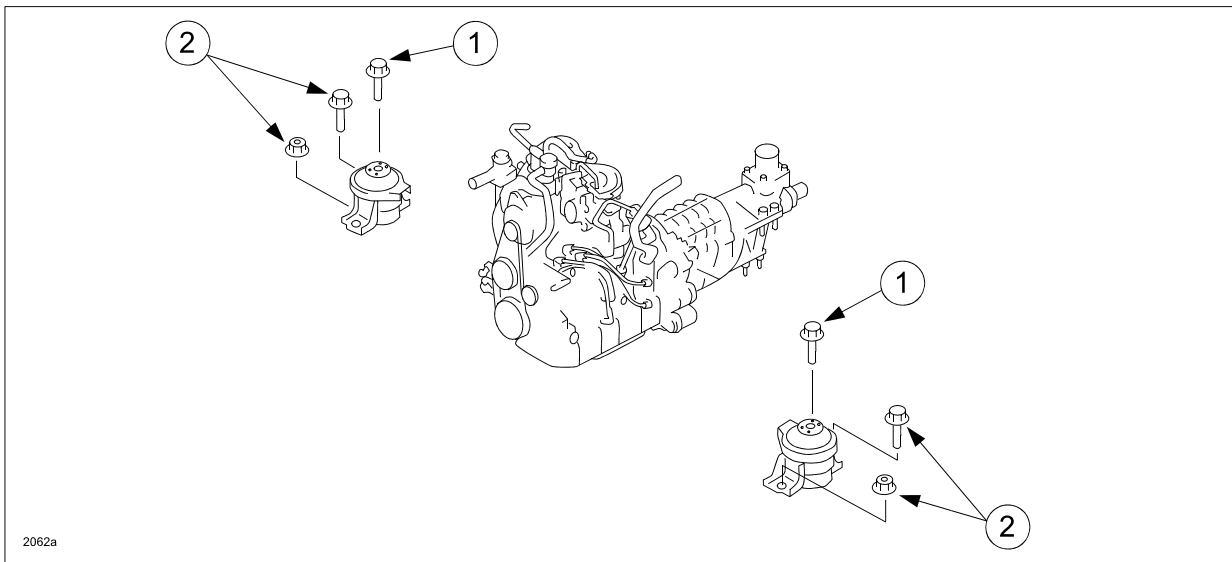

8. On LH side of engine, remove bolts/nuts in the following order:
  - a. Engine mount bracket-to-engine mount (1).  
Tightening Torque: 37-52 N.m (28-38 ft-lb)
  - b. Engine mount-to-front sub frame (2).  
Tightening Torque: 45-63 N.m (33-46 ft-lb)
9. To install, reverse removal procedure.
10. Verify repair.

## PART(S) INFORMATION

Part Number	Description	Qty.	Notes
FE05-39-040A	Engine Mount Rubber - MT	1	RH
FE05-39-050A	Engine Mount Rubber - MT	1	LH
FE01-39-040A	Engine Mount Rubber - AT	1	RH
FE01-39-050A	Engine Mount Rubber - AT	1	LH

## WARRANTY INFORMATION

### NOTE:

- This warranty information applies only to verified customer complaints on vehicles eligible for warranty repair.
- As for the left-side of engine mount rubber, claim it as a related part.
- This repair will be covered under Mazda's New Vehicle Limited Warranty term for a **Powertrain Component**.
- Additional diagnostic time cannot be claimed for this repair.

Warranty Type	A
Symptom Code	83
Damage Code	9M
Part Number Main Cause	FE05-39-040A or FE01-39-040A
Quantity	1
Operation Number / Labor Hours:	XXD5BXRX / 0.8 Hrs.