

<b>Subject:</b> <b>MT - UNUSUAL NOISE WHEN CLUTCH PEDAL IS DEPRESSED</b>	<b>Bulletin No:</b> 05-011/06
	<b>Last Issued:</b> 10/26/2006

## APPLICABLE MODEL(S)/VINS

2004-2007 RX-8 with VINs lower than JM1 FE\*\*\*\* \*\* 209819 (built prior to September 25, 2006)

## DESCRIPTION

Some vehicles may exhibit a squeaking noise when the clutch pedal is depressed. This noise may be the clutch cut switch.

Customers having this concern should have their vehicle repaired using the following repair procedure.

## REPAIR PROCEDURE

1. Verify customer concern.
2. Replace clutch cut switch with a revised part.

### NOTE:

- Ensure clutch cut switch locks into position when installing.
3. Verify repair.

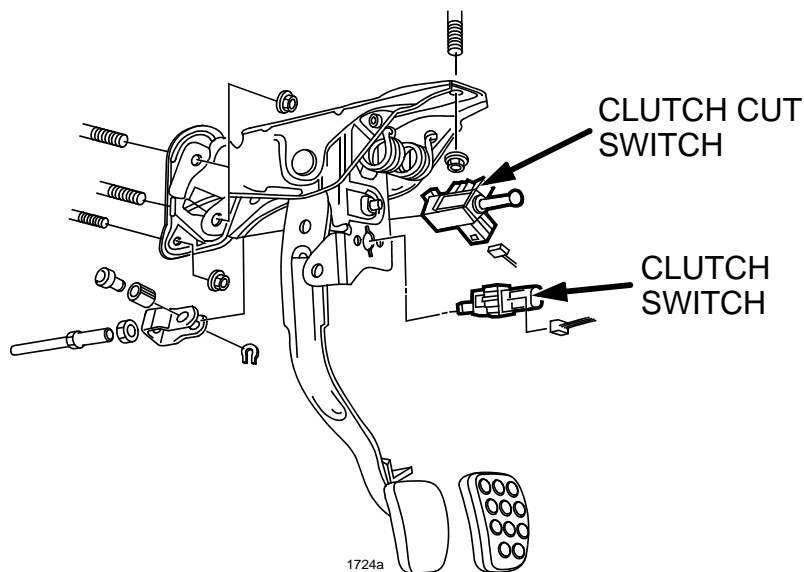

<b>Bulletin No:</b> 05-011/06 © 2006 Mazda Motor of America, Inc.	<b>Last Issued:</b> 10/26/2006
--	--------------------------------

## PART(S) INFORMATION

Part Number	Description	Qty.	Notes
D374-66-4D0A	Clutch Cut Switch	1	---

## WARRANTY INFORMATION

### NOTE:

- This warranty information applies only to verified customer complaints on vehicles eligible for warranty repair. Refer to the Warranty Wizard for warranty term information.
- Additional diagnostic time cannot be claimed for this repair.

Warranty Type	A
Symptom Code	82
Damage Code	9B
Part Number Main Cause	D374-66-4D0A
Quantity	1
Operation Number / Labor Hours:	XXB435RX / 0.2 Hrs